

## Cavity wall lintels - Light duty

# CA12 range

CA12 Lintels are economic, light duty cavity wall lintels, designed especially for the common applications of small spans and light loads such as masonry above, or a lightly loaded timber floor.

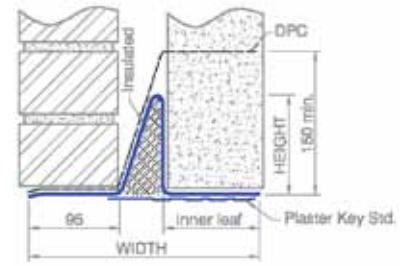

Specification table for CA12 Lintels

Nominal cavity size (mm)	Nominal inner leaf (mm)	SPECIFY	Overall Height (mm)	Overall Width (mm)	Steel Gauge (mm)	Mass (kg/m)	Form Type	Ixx (cm <sup>4</sup> )	Zxx (cm <sup>3</sup> )
47-56	100-115	CA12-100/50/100	131	241	2.0	7.2	1	178.1	19.57
	125-140	CA12-100/50/125	131	266	2.0	7.6	1	185.2	19.91
	190-215	CA12-100/50/190	133	331	2.0	11.1	2	232.4	21.92
57-71	100-115	CA12-100/60/100	129	252	2.0	7.2	1	170.8	18.98
	125-140	CA12-100/60/125	129	277	2.0	7.6	1	177.5	19.29
	190-215	CA12-100/60/190	131	342	2.0	11.4	2	224.6	20.99
72-84	100-115	CA12-100/75/100	126	267	2.0	7.1	1	161.9	18.40
	125-140	CA12-100/75/125	126	292	2.0	7.5	1	168.4	18.71
	190-215	CA12-100/75/190	128	357	2.0	11.5	2	214.4	20.42
85-96	100-115	CA12-100/90/100	124	280	2.0	7.2	1	156.5	17.99
	125-140	CA12-100/90/125	124	305	2.0	7.6	1	162.7	18.28
	190-215	CA12-100/90/190	126	370	2.0	11.6	2	207.9	20.18
97-119	100-115	CA12-100/100/100	120	292	2.0	7.2	1	151.7	17.85
	125-140	CA12-100/100/125	120	317	2.0	7.6	1	154.9	18.01
	190-215	CA12-100/100/190	122	382	2.0	11.6	2	198.4	19.84
120-139	100-115	CA12-100/120/100	117	315	2.0	7.5	3	157.5	20.19
	125-140	CA12-100/120/125	117	339	2.0	7.9	3	164.5	20.82
	190-215	CA12-100/120/190	119	404	2.0	12.7	4	222.0	23.62
140-160	100-115	CA12-100/140/100	114	334	2.0	7.8	3	158.1	21.36
	125-140	CA12-100/140/125	114	359	2.0	8.1	3	165.5	21.78
	190-215	CA12-100/140/190	116	425	2.0	13.2	4	228.6	24.58

Need a stronger lintel?  
See our CA16 >

Allowable load for all CA12 Lintels\*

Opening Span	Lintel Length	Max total load (kN)*	Load Example (see pg 85)
450	750	31.0	masonry & timber floor
600	900	31.0	
750	1050	31.0	
900	1200	31.0	
1050	1350	30.0	
1200	1500	27.3	full height masonry
1350	1650	24.6	
1500	1800	22.3	
1650	1950	19.1	
1800	2100	16.1	
1950	2250	13.7	450mm of masonry
2100	2400	11.8	
2250	2550	10.3	
2400	2700	9.0	

Intermediate sizes can be produced

Permissible Moment\*: 2.1 kN.m

Permissible Point Load\*: 3.0 kN

LOAD LOAD RATIO LIMITS\* (OUTER : INNER)  
65-100% Max load: 1:1 - 1:3 OR < 65% Max Load: 2:1 - 1:5

\*See page 78 for loading & Installation guide

NOTES: The actual lintel form varies over the range to maintain uniform load capacity, see bottom page 12. Although made of stainless steel, CA12 lintels require a separate DPC to meet the building regulation requirement of 150mm fall across the cavity.

### SPECIFYING OPTIONS FOR CA-TYPE LINTELS.

The specification convention for CA lintels is shown to the right with an example.

Should you require something different from the standard lintels listed in the tables, the specification components in blue can be varied to achieve non standard dimensions and features; such as a stepped outer, flat base (no plaster key), or shorter or longer inner and outer leaf supports as shown in the example to the right. Most imaginable variations can be manufactured, and the lead time is often the same as for standard lintels

